

REVISIONS					
REV.	POS.	DESCRIPTION	DATE	DRW	APP
A		INITIAL CREATION	2013/01/01	Gary	Mason

Curve Chart(Be Confined To TEC1-161124040):

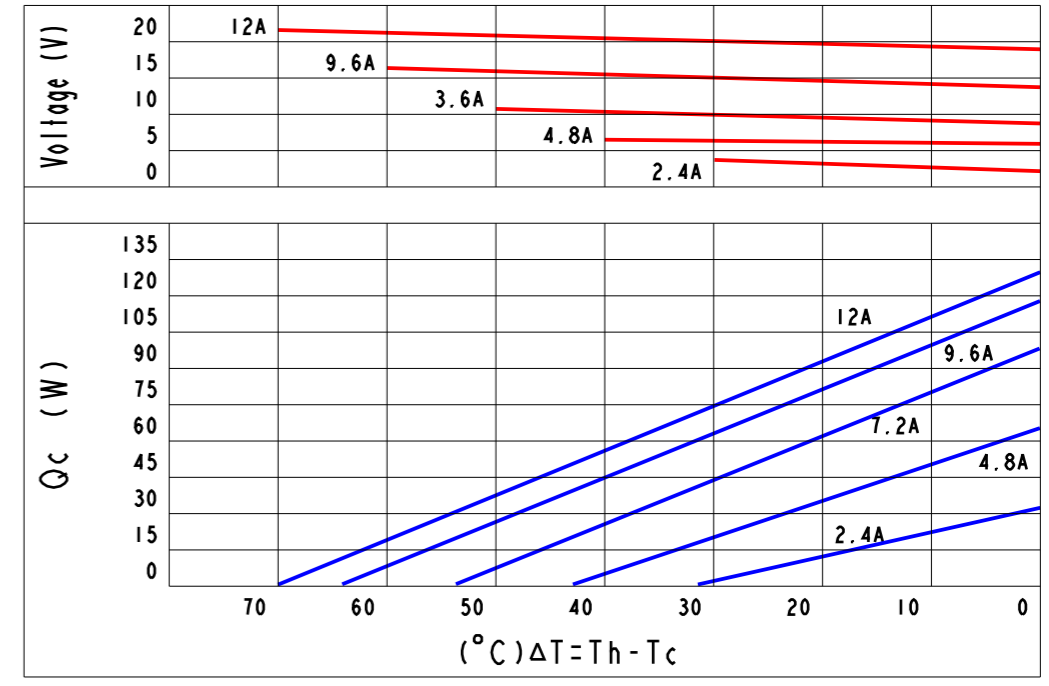

Part Number And Feature:

T	E	C	I	-	1	6	1	x	x	4	5	4	5	Sealing	YES
↓	↓				↓	↓	↓	↓	↓	↓	↓	↓	↓	Operation Temperature	125°C(Max.)
Thermo	Electric	Chip	Stage	Stack	N & P	Stack	Quantity	Current	A(Max.)	Dimension	(A)	Dimension	(B)	Melting Point	138°C
														Storage Temperature	-60°C~100°C
														RoHS	YES

Technical Data:

ITEM	Part NO.	Stack(P&N)	A(Max.)	V(Max.)	Qc(W) /Th=27°C/ ΔT(°C)	DIM(A)	DIM(B)	DIM(H)
1	TEC1-161034545	161	3 A	19.1 V	42W	70°C	45	45
2	TEC1-161044545	161	4 A	19.1 V	49W	70°C	45	45
3	TEC1-161064545	161	6 A	19.1 V	65W	70°C	45	45
4	TEC1-161084545	161	8 A	19.1 V	91W	70°C	45	45
5	TEC1-161094545	161	9 A	19.1 V	105W	70°C	45	45
6	TEC1-161104545	161	10 A	19.1 V	115W	70°C	45	45
7	TEC1-161124545	161	12 A	19.1 V	130W	70°C	45	45

Notes:

1. Printing always on cold side.
2. Tolerance of thermo and electric parameters ±10%.
3. Please mount heat sink before you use it. also, please do not exceed the extra voltage at any time.
4. Please contact with us if you need Melting Point 183°C (Operation Temperature 150°C Max.) and 235°C (Operation Temperature 200°C Max.) type.



*DO NOT SCALE DRAWING

THIRD ANGLE PROJECTION

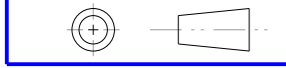

THIS DRAWING AND THE DATA DISCLOSED HEREIN OR HEREWITH IS NOT TO BE REPR ODUCE
USED OR DISCLOSED OR IN PART TO ANYONE WITHOUT THE PERMISSION OF KJLP (SHENZHEN) ELECTRONICS
CO., LTD.

1. UNLESS OTHERWISE SPECIFIED,
DIMENSIONS ARE MM
2 TOLERANCE ARE AS FOLLOWS:
0 < X < 2 ± 0.06
2 < X < 10 ± 0.08
10 < X < 50 ± 0.12
50 < X < 100 ± 0.16
100 < X < 200 ± 0.20
200 < X < 300 ± 0.30
ANGLES ± 0.5°

PART NO.	TEC1-161xx4545	DESCRIPTION	DC 19.1V(Max.), 3~12A(Max.), 161 P&N, 45*45mm
SIGNATURE		DATE	
DRAWN BY	Gary	2013/01/01	
CHECKED BY	Justin	2013/01/01	
ENGR	Vivi	2013/01/01	
APPROVED BY	Mason	2013/01/01	
ISSUED BY	Jack	2013/01/01	
CAD MODLE:	TEC1-161xx4545.prt	SCALE:	1:1
CAD DWG:	TEC1-161xx4545.dwg	SIZE:	A3
		REV:	A
		SHEET:	1 OF 1

昆晶冷片(深圳)电子有限公司
KJLP (SHENZHEN) ELECTRONICS CO., LTD
email: kjlp@kjlp.net http:// www.kjlp.net
Tel: +86-755-82528352 Fax: +86-755-22639899